

Phase 1 EAST END CONSTRUCTION

Schedule III

January 2015 – April 2015

10R TORA/TODA shortened to allow daytime work beyond 10R departure end.

10R LDA/ASDA: 6,435'

10R TORA/TODA: 5,735'

28L LDA: 6,611'

28L ASDA/TORA/TODA: 6,611'

Phase 1, Schedule III

January 2015 – April 2015

Potential Nighttime runway closures

(11:30 PM – 5:30 AM) check NOTAMs

10R ILS Approach (GS & LOC) out of service

2/17/15 – 3/26/15

Anticipated date of new procedures publication:

4/30/15

NO.	DATE	REVISION	BY	APPD.

NO.	DATE	REVISION	BY	APPD.

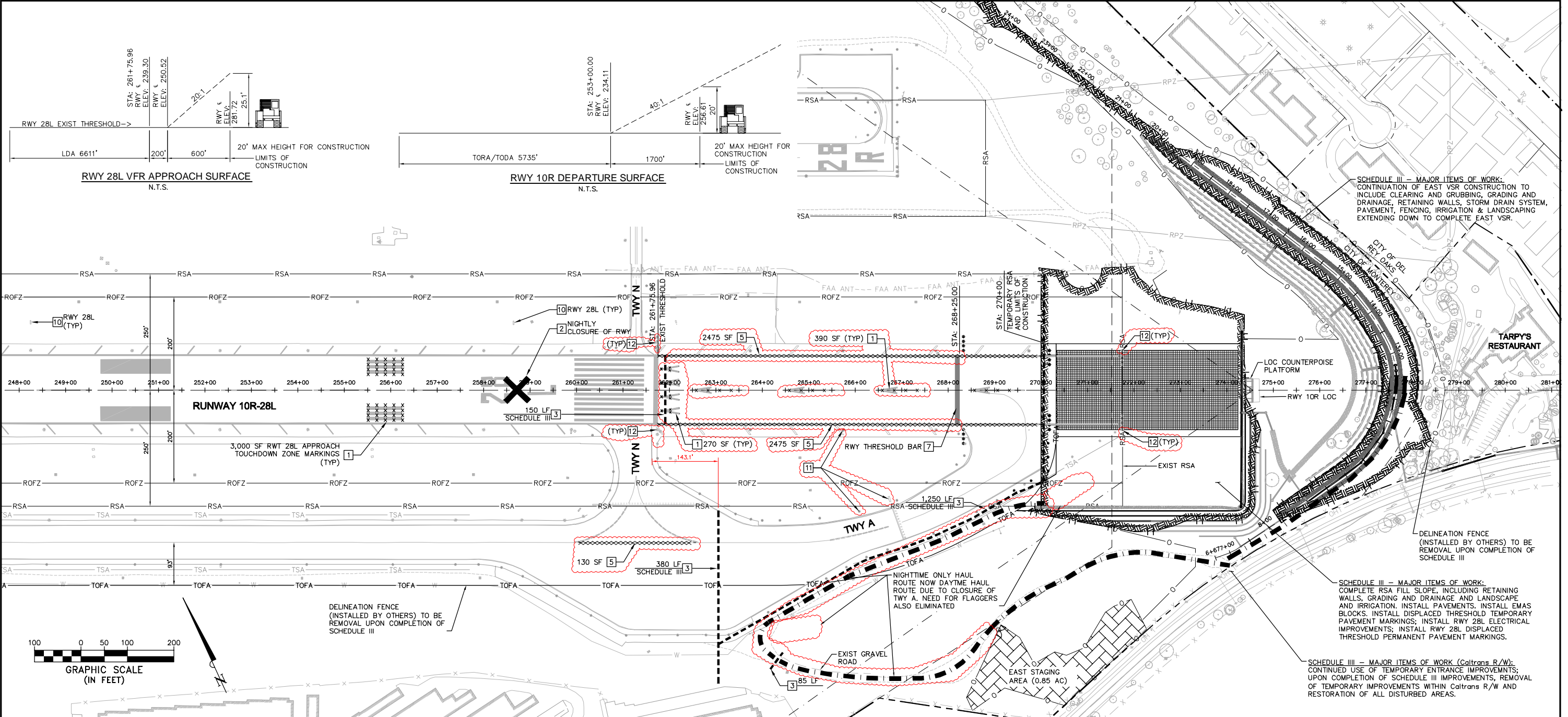

SCHEDULE III - MAJOR ITEMS OF WORK:
 CONTINUATION OF EAST VSR CONSTRUCTION TO INCLUDE CLEARING AND GRUBBING, GRADING AND DRAINAGE, RETAINING WALLS, STORM DRAIN SYSTEM, PAVEMENT, FENCING, IRRIGATION & LANDSCAPING EXTENDING DOWN TO COMPLETE EAST VSR.

DELINEATION FENCE (INSTALLED BY OTHERS) TO BE REMOVAL UPON COMPLETION OF SCHEDULE III

SCHEDULE III - MAJOR ITEMS OF WORK:
 COMPLETE RSA FILL SLOPE, INCLUDING RETAINING WALLS, GRADING AND DRAINAGE AND LANDSCAPE AND IRRIGATION. INSTALL PAVEMENTS. INSTALL EMAS BLOCKS. INSTALL DISPLACED THRESHOLD TEMPORARY PAVEMENT MARKINGS; INSTALL RWY 28L ELECTRICAL IMPROVEMENTS; INSTALL RWY 28L DISPLACED THRESHOLD PERMANENT PAVEMENT MARKINGS.

SCHEDULE III - MAJOR ITEMS OF WORK (Caltrans R/W):
 CONTINUED USE OF TEMPORARY ENTRANCE IMPROVEMENTS; UPON COMPLETION OF SCHEDULE III IMPROVEMENTS, REMOVAL OF TEMPORARY IMPROVEMENTS WITHIN CALTRANS R/W AND RESTORATION OF ALL DISTURBED AREAS.

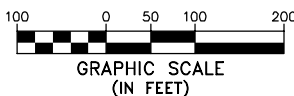

GENERAL NOTES

- THE EXACT LOCATION AND LIMITS OF THE TYPE 1 LOW PROFILE BARRICADES AS SHOWN ON THIS SHEET MAY BE MODIFIED IN THE FIELD BY THE ENGINEER AT NO ADDITIONAL COST TO THE OWNER.
- RUNWAY 10R-28L AND ALL OTHER NON-MOVEMENT AND MOVEMENT AREAS WITHIN THE AOA WHICH ARE NOT DESIGNATED TO BE CLOSED TO AIRCRAFT TRAFFIC, SHALL REMAIN OPEN TO AIRCRAFT OPERATIONS AT ALL TIMES DURING CONSTRUCTION.
- CONTRACTOR SHALL INSTALL RUNWAY AND TAXIWAY PAVEMENT MARKINGS IN COMPLIANCE WITH ADVISORY CIRCULARS 150/5370-2F AND 150/5340-1K PRIOR TO OPENING RUNWAY 10R-28L TO AIRCRAFT LANDING AND TAKE-OFF OPERATIONS. AS A MINIMUM FOR SAFE RUNWAY OPERATIONS MARKINGS SHALL INCLUDE: RUNWAY DESIGNATION; DISPLACED THRESHOLD BAR AND ARROWHEADS; RUNWAY CENTERLINE; RUNWAY EDGE MARKINGS; DEMARCATION BAR AND ARROWHEADS (IN VFR CONDITION); RUNWAY AIMING POINTS; RUNWAY TOUCHDOWN MARKINGS; AND ALL TAXIWAY LEAD-IN LINES.
- DECLARED DISTANCES FOR RUNWAY 10R LENGTHS DURING CONSTRUCTION ARE AS FOLLOWS:

LDA	ASDA	TORA	TODA
6,435 FT	6,433 FT	5,735 FT	5,735 FT
- DECLARED DISTANCES FOR RUNWAY 28L LENGTHS DURING CONSTRUCTION ARE AS FOLLOWS:

LDA	ASDA	TORA	TODA
6,611 FT	6,611 FT	6,611 FT	6,611 FT
- ALL STATION AND OFFSETS ARE TAKEN FROM RUNWAY 10R-28L CENTERLINE.

PHASING CONSTRUCTION/DEMOLITION NOTES:

- ITEMS TO BE TEMPORARILY INSTALLED, AND MARKINGS TO BE OBLITERATED.
- OBLITERATE EXISTING PAVEMENT MARKINGS
 - LIGHTED "X" RUNWAY CLOSURE SIGNAL SEE DETAIL 2 ON SHEET CPD-0.2
 - TYPE 1 LOW PROFILE BARRICADE (LENGTH PER PLAN) SEE DETAIL 1 ON SHEET CPD-0.2
 - TEMPORARY PAVEMENT MARKING (P-620)
 - BLACK OUT EXISTING PAVEMENT MARKINGS
 - FLAGGER CONTROLLED CROSSING
 - PAVEMENT MARKING TAPE (PAVEMENT MARKING AS NOTED)
 - COVER EXISTING RDR SIGNS
 - COVER OR DE-ENERGIZE EXISTING RUNWAY EDGE LIGHTS, RUNWAY END LIGHTS, TAXIWAY EDGE LIGHTS, AND DIRECTIONAL SIGNS
 - EXISTING THRESHOLD LIGHTS TO BE REMOVED AND SALVAGED. EXISTING RUNWAY END LIGHTS TO BE RELOCATED TO THRESHOLD LOCATION ON EXISTING CANS. RUNWAY END LIGHTS LENSES TO BE RECONFIGURED FROM RED/RED TO RED (WEST)/GREEN (EAST) BY MPAD PERSONNEL. CONTRACTOR TO COORDINATE WITH MPAD PRIOR TO START OF WORK DURING SCHEDULE III PRE-PHASE CONSTRUCTION MEETING

CONTRACTOR RESTRICTIONS AND LIMITATIONS

- ALL WORK NECESSARY FOR CHANGING RUNWAY 28L TO A VFR RUNWAY INCLUDING: TEMPORARY PAVEMENT MARKINGS FOR THE DEMARCATION BAR AND ARROWS AND THE MODIFIED TAXIWAY LEAD-IN LINE AND TAXIWAY EDGE MARKINGS; THE BLACK OUT OF EXISTING RUNWAY EDGE STRIPS; THE OBLITERATION OF EXISTING RUNWAY DISPLACED THRESHOLD ARROW AND TAIL MARKINGS AND THE TAXIWAY CENTERLINE AND EDGE MARKINGS; AND THE ENERGIZING OF THE TEMPORARY RELOCATED DISPLACED THRESHOLD LIGHTS AND TEMPORARY REIL'S SHALL BE COMPLETED DURING ONE (1) NIGHT-TIME CLOSURE OF RUNWAY 10R-28L.
- INSTALLATION AND SUBSEQUENT REMOVAL OF PAVEMENT MARKING TAPE FOR RNAV FLIGHT CHECK SHALL BE COMPLETED IN ONE NIGHT-TIME CLOSURE OF RUNWAY 10R-28L.
- CONSTRUCTION EQUIPMENT, PERSONNEL, AND MATERIAL CANNOT PENETRATE THE RWY 28L APPROACH SURFACE WHEN RUNWAY IS OPERATIONAL.
- CONSTRUCTION EQUIPMENT, PERSONNEL, AND MATERIAL CANNOT PENETRATE THE RWY 10R DEPARTURE SURFACE WHEN RUNWAY IS OPERATIONAL.
- CONSTRUCTION EQUIPMENT, PERSONNEL, AND MATERIAL CANNOT ENTER THE TEMPORARY RSA WHEN RUNWAY IS OPERATIONAL.
- MINIMUM WINGTIP CLEARANCE FOR TDG 3 OF 34-FT MUST BE MAINTAINED WHEN RUNWAY IS OPERATIONAL.
- CONSTRUCTION EQUIPMENT, PERSONNEL, AND MATERIAL CANNOT PENETRATE THE TAXIWAY 'A' OFA WHEN TAXIWAY IS OPERATIONAL.
- WHEN RUNWAY 10R-28L IS CLOSED, CITY OF MONTEREY NOISE RESTRICTIONS APPLY.
- GRADING WITHIN RSA MUST BE IN COMPLIANCE WITH FAA ADVISORY CIRCULAR 150/5370-2 (LATEST EDITION) TO PERMIT DAYTIME USE OF RUNWAY.
- DURING EMAS INSTALLATION, INDIVIDUAL ROWS OF BLOCKS MUST BE COMPLETED AT THE END OF EACH WORK SHIFT. PARTIALLY COMPLETED ROWS WILL NOT BE ALLOWED.
- UPON COMPLETION OF THE EMAS BLOCKS, THE INSTALLATION OF THE PAVEMENT MARKINGS FOR THE RUNWAY 28L DISPLACED THRESHOLD FINAL CONFIGURATION SHALL BE COMPLETED DURING ONE (1) NIGHT-TIME CLOSURE OF RUNWAY 10R-28L. MINIMUM PAVEMENT MARKINGS SHALL INCLUDE: RUNWAY DESIGNATION; THRESHOLD BAR AND ARROWHEADS; DISPLACED THRESHOLD ARROWHEAD AND MARKINGS; RUNWAY CENTERLINE; AND THE OBLITERATION OF ALL TEMPORARY PAVEMENT MARKINGS. ALL MARKINGS TO COMPLETE THE RUNWAY PAVEMENT MARKING SHALL BE CARRIED OUT DURING SUBSEQUENT RUNWAY NIGHTLY-CLOSURES.

MAJOR WORK ITEMS FOR THIS SCHEDULE

- AIRFIELD IMPROVEMENTS:**
- TEMPORARY PAVEMENT MARKINGS FOR ALIGNED TAXIWAY PROCEEDING RUNWAY 28L VFR APPROACH INCLUDING TAXIWAY CENTERLINE AND EDGE MARKINGS, RUNWAY DEMARCATION BAR AND ARROWS; BLACK OUT OF EXISTING RUNWAY EDGE STRIPS; OBLITERATION OF EXISTING RUNWAY DISPLACED THRESHOLD MARKING ARROW AND TAIL; DE-ENERGIZING THE RUNWAY LIGHTS AND SIGNS FOR THE ALIGNED TAXIWAY; COVER RWY 28L DEPARTURE RDR'S; INSTALLATION OF PAVEMENT MARKING TAPE FOR RNAV FLIGHT CHECK, AND REMOVAL OF THE MARKING TAPE UPON COMPLETION OF THE FLIGHT CHECK.
 - RUNWAY 28L APPROACH RSA FILL SLOPE COMPLETION; EXISTING PAVEMENT REMOVAL; FINAL GRADING AND DRAINAGE; RUNWAY MILL AND FILL; EMAS ANCHOR BEAM INSTALLATION; EMAS BED PAVEMENT INSTALLATION; EMAS BLOCKS INSTALLATION; INSTALLATION OF THE RUNWAY END LIGHTS AND APPURTENANCES; RECONFIGURING TAXIWAY 'A' EDGE LIGHTS
 - INSTALLATION AND SUBSEQUENT REMOVAL OF PAVEMENT MARKING TAPE FOR RNAV FLIGHT CHECK.
 - REMOVAL OF ALL TEMPORARY MARKINGS; INSTALLATION OF TEMPORARY PAVEMENT MARKINGS IN THE FINAL RUNWAY CONFIGURATION; ENERGIZING OF FINAL RUNWAY AND TAXIWAY AIRFIELD LIGHTS.
 - COORDINATION ON THE INSTALLATION OF NEW PAPI AND REIL'S FOR RUNWAY 28L APPROACH AND THE FAA FLIGHT CHECK (INSTALLATION OF PAPI'S AND REIL'S ARE NOT PART OF THIS CONTRACT).
 - WHERE MARKINGS ARE LOCATED ON NEW PAVEMENT THE FINAL PAVEMENT MARKING APPLICATION SHALL BE INSTALLED AFTER THE PAVEMENT CURE PERIOD OF 30 DAYS HAS ELAPSED.
 - EXISTING RUNWAY EDGE LIGHTS TO BE TEMPORARILY RECONFIGURED FROM WHITE/WHITE TO AMBER (WEST)/WHITE (EAST) BY MPAD PERSONNEL. SEE RE-ISSUED SHEET E-1.3 FOR DETAILS.

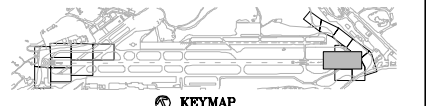

**MONTEREY PENINSULA AIRPORT DISTRICT
 RUNWAY 10R-28L
 SAFETY AREA IMPROVEMENTS
 AIP NO.: 3-06-0159-58**

**CONSTRUCTION PHASING PLAN
 PHASE 1
 SCHEDULE III**

**Kimley-Horn
 and Associates, Inc.**
 © 2014 KIMLEY-HORN AND ASSOCIATES, INC.
 763 The City Drive, Suite 200
 Orange, California 92668 (714) 939-1030

DESIGNED	PM	DRAWN	TJ	CHECKED	VH
PROJECT NO.	094584000				
DATE:	01/03/2014				
SHEET NO.	CP-1.2				
17 of 301					



© 2014 KIMLEY-HORN AND ASSOCIATES, INC. ALL RIGHTS RESERVED. THIS DOCUMENT IS THE PROPERTY OF KIMLEY-HORN AND ASSOCIATES, INC. AND IS NOT TO BE REPRODUCED OR TRANSMITTED IN ANY FORM OR BY ANY MEANS, ELECTRONIC OR MECHANICAL, INCLUDING PHOTOCOPYING, RECORDING, OR BY ANY INFORMATION STORAGE AND RETRIEVAL SYSTEM, WITHOUT THE WRITTEN PERMISSION OF KIMLEY-HORN AND ASSOCIATES, INC.